

INPUT SHAFT

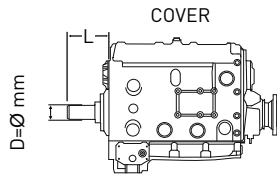

COVER

D=Ø mm

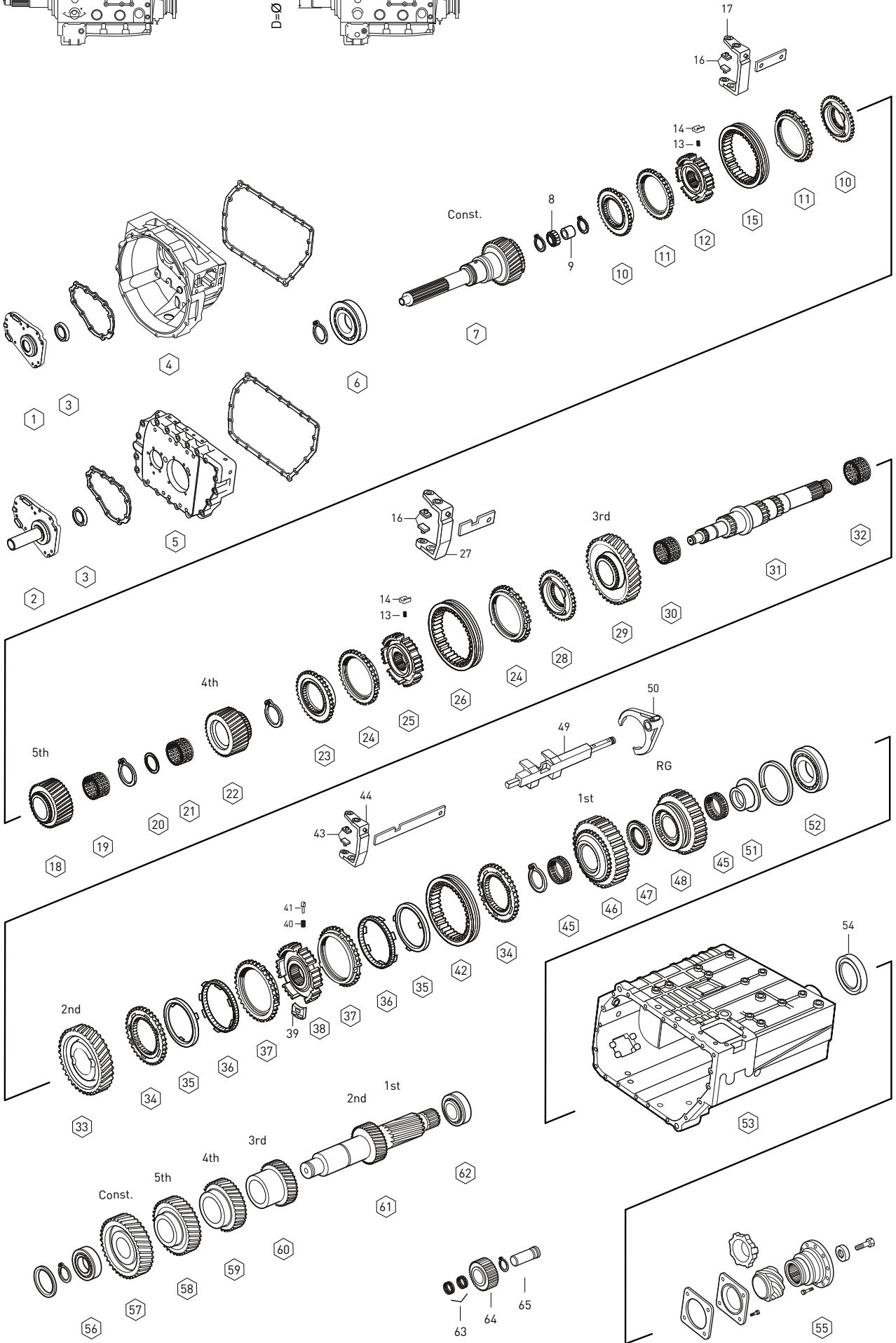

Fig.	Kacmaz No.	Oem No	Oem Old No	Pcs.	Ürün Tanımı	Description	Sizes	Notes	SG 6.72-0.79	DG 8.50-1.00
1	K20.00673	1290 302 401		1	PRİZDİREK KEÇE KAPAĞI	COVER	D=82H10 1 1/2	AG	◆	
1		1290 302 430		1	PRİZDİREK KEÇE KAPAĞI	COVER	D=82H10 1 3/4	B	◆	
2		1290 302 431		1	PRİZDİREK KEÇE KAPAĞI	COVER	L=153 D=47.5	A	◆	
2		1290 302 389		1	PRİZDİREK KEÇE KAPAĞI	COVER	L=136 D=57	CD	◆	
2		1290 302 408		1	PRİZDİREK KEÇE KAPAĞI	COVER	L=190 D=47.5	D		◆
2		1290 302 447		1	PRİZDİREK KEÇE KAPAĞI	COVER	L=185 D=47.6	EF		◆
2	K20.00674	1290 302 437		1	PRİZDİREK KEÇE KAPAĞI	COVER	L=136 D=57	H		◆
3		0750 111 476		1	PRİZDİREK ÖN KEÇE	OIL SEAL	42X62X10mm	ACDEF	◆	◆
3	K20.01001	0750 111 149	(0734 310 161)	1	PRİZDİREK ÖN KEÇE	OIL SEAL	48X65X10mm	BH	◆	◆
3	K20.01027	0750 111 469	(0750 111 268)	1	PRİZDİREK ÖN KEÇE	OIL SEAL	60X74X10mm	G		◆
4		1290 201 227		1	ŞANZIMAN ÖN GÖVDE	HOUSING		A	◆	
4		1290 201 245		1	ŞANZIMAN ÖN GÖVDE	HOUSING		G	◆	
4		1290 201 167		1	ŞANZIMAN ÖN GÖVDE	HOUSING		B	◆	
5		1290 301 176		1	ŞANZIMAN ÖN GÖVDE	HOUSING		ACDEFH	◆	◆
6	K20.01139	0735 330 685		1	PRİZDİREK ÖN BİLYA	ROLLER BEARING	60.0X116.0X28.0mm	ACDEF	◆	◆
6	K20.01140	0735 330 800		1	PRİZDİREK ÖN BİLYA	ROLLER BEARING	55.0X116.0X28.0mm	GH	◆	◆
7		1290 302 478		1	PRİZDİREK	INPUT SHAFT	L=252 SAE 1 1/2	A	◆	
7		1290 302 465		1	PRİZDİREK	INPUT SHAFT	L=252 SAE 1 3/4	B	◆	
7		1290 302 482		1	PRİZDİREK	INPUT SHAFT	L=238 SAE 1 1/2	C	◆	
7		1290 302 480		1	PRİZDİREK	INPUT SHAFT	L=238 SAE 1 1/2	D		◆
7		1290 302 472		1	PRİZDİREK	INPUT SHAFT	L=286 SAE 1 1/2	E		◆
7		1290 302 493		1	PRİZDİREK	INPUT SHAFT	L=286 SAE 1 1/2	F		◆
7	K20.00675	1290 302 511		1	PRİZDİREK	INPUT SHAFT	L=252 SAE 1 1/2	G	◆	
7	K20.00676	1290 302 512		1	PRİZDİREK	INPUT SHAFT	L=238 SAE 1 3/4	H		◆
8	K20.01141	0735 358 128	(0750 115 135)	1	KAMALI MİL UÇ BİLYA	NEEDLE CAGE	31.0X46.0X27.2mm		◆	◆
9	K20.01707	0735 295 119	(0730 161 354)	1	KAMALI MİL UÇ BİLYA BURCU	BUSHING	25.0X31.0X26.0mm		◆	◆
10	K20.00677	1290 304 482	(1290 304 505)	2	PRİZ.VE 5.VİT.SENKROMENÇ	ENGAGING RING			◆	◆
11	K20.00678	1317 304 150		2	PRİZ.VE 5.VİT.FRENLEME	SYNCHRONIZING CONE			◆	◆
12	K20.00679	1317 304 026		1	PRİZ.VE 5.VİT.YILDIZ DIŞLI	GUIDE SLEEVE		ABCDEF	◆	◆
12	K20.00680	1290 304 586		1	PRİZ.VE 5.VİT.YILDIZ DIŞLI	GUIDE SLEEVE		GH	◆	◆
13	K20.00681	0732 042 510		6	PRİZ.VE YILDIZ DIŞLI YAYI	SPRING			◆	◆
14	K20.00682	1317 304 081		6	PRİZ.VE YILDIZ DIŞLI FİŞEĞİ	PRESSURE PIECE			◆	◆
15	K20.00683	1317 304 126		1	PRİZ.VE 5.VİT.SENK.HALKA	ENGAGING SLEEVE			◆	◆
16	K20.00684	1290 306 423		4	5.-3./4.VİT.HİLAL PABUCU	SLIDING PAD			◆	◆
17	K20.00685	1290 206 130		1	PRİZ.VE 5.VİT.HİLALİ	GEAR SHIFT FORK Const./5th			◆	
17	K20.00686	1290 206 132		1	PRİZ.VE 5.VİT.HİLALİ	GEAR SHIFT FORK Const./5th				◆
18	K20.00687	1290 304 547		1	5.VİTES DİŞLİSİ	GEAR 5th		ABCG	◆	
18	K20.00688	1290 304 548		1	5.VİTES DİŞLİSİ	GEAR 5th		DEFH		◆
19	K20.01339	0735 321 527		1	5.VİT.MASURA BİLYA	NEEDLE CAGE	44.0X50.0X45.0mm		◆	◆
20	K20.01708	0730 112 265		1	4./5.VİTES ARA PULU	THRUST WASHER	7.00mm		◆	◆
21	K20.01340	0735 321 528		1	4.VİT.MASURA BİLYA	NEEDLE CAGE	60.0X68.0X30.0mm		◆	◆

NOTES :

ABCDEFHG alphabetic letters are used in conjunction with the encoded parts. Alphabetical Coding has been done according to Input Shaft

NOTLAR :

ABCDEFHG alfabetik harfler ile kodlanan parçalar birlikte kullanılır. Alfabetik kodlamalar prizdireklere göre yapılmıştır.

6 S 8 5 0

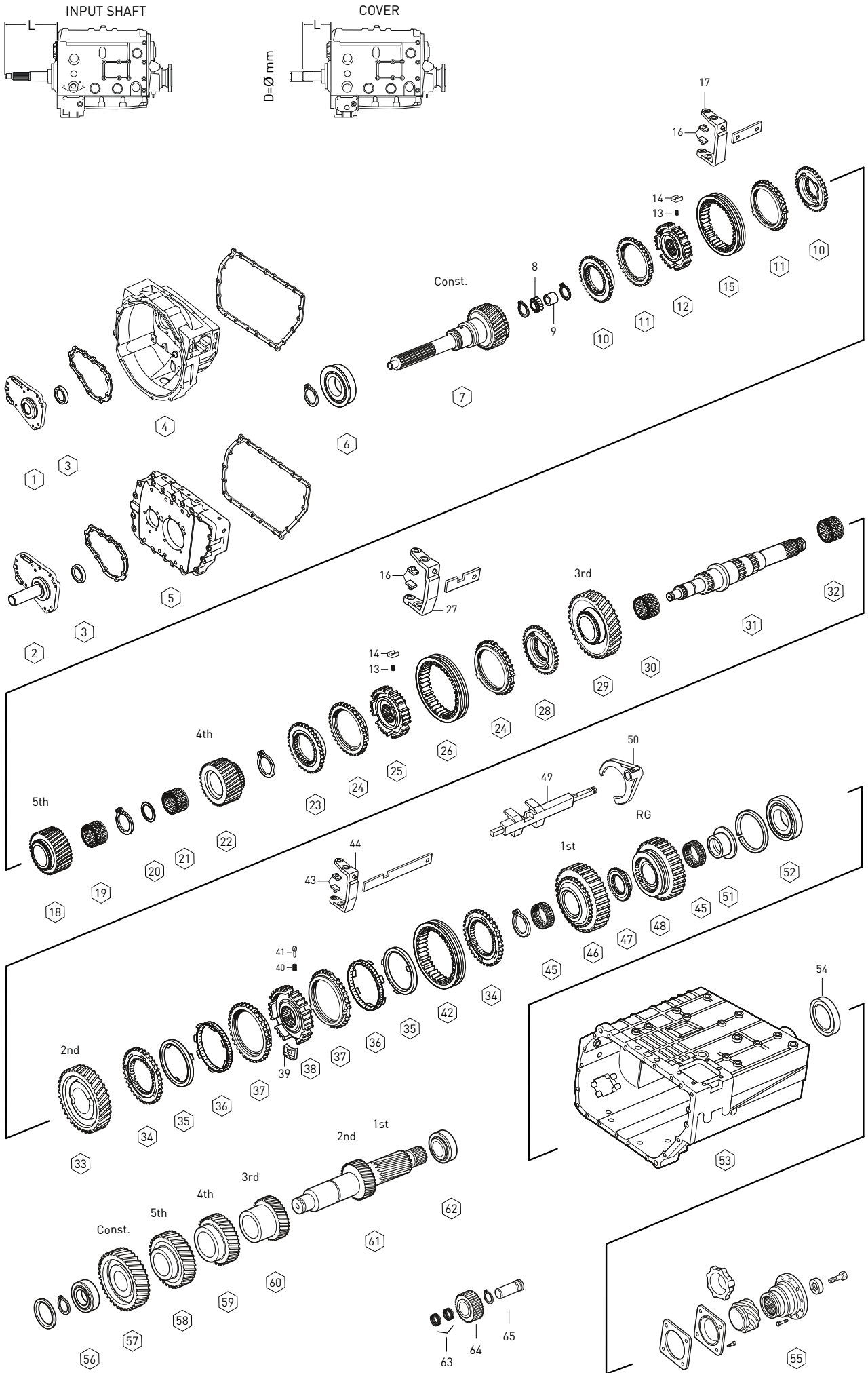

Fig.	Kacmaz No.	Oem No	Oem Old No	Pcs.	Ürün Tanımı	Description	Sizes	Notes	SG 6.72-0.79	DG 8.50-1.00
22	K20.00689	1290 304 574		1	4.VİTES DİŞLİSİ	GEAR 4th		A	◆	◆
23	K20.00690	1290 304 508		1	4.VİT.SENKROMENÇ	ENGAGING RING			◆	◆
24	K20.00691	1317 304 114	(1317 304 149)	2	3./4.VİT.FRENLEME	SYNCHRONIZING CONE			◆	◆
25	K20.00692	1317 304 031		1	3./4.VİT.YILDIZ DİŞLİ	GUIDE SLEEVE			◆	◆
26	K20.00693	1317 304 125		1	3./4.VİT.SENK.HALKA	ENGAGING SLEEVE			◆	◆
27	K20.00694	1290 206 128		1	3./4.VİTES HİLALİ	GEAR SHIFT FORK 3rd/4th			◆	◆
28	K20.00695	1290 304 509		1	3.VİT.SENKROMENÇ	ENGAGING RING			◆	◆
29	K20.00696	1290 304 581		1	3.VİTES DİŞLİSİ	GEAR 3rd			◆	◆
30	K20.01341	0735 321 529		1	3.VİT.MASURA BİLYA	NEEDLE CAGE	75.0X83.0X40.0mm		◆	◆
31	K20.00697	1290 304 571		1	KAMALI MİL	MAIN SHAFT		ABCDEF	◆	◆
31	K20.00698	1290 304 620	(1290 304 587)	1	KAMALI MİL	MAIN SHAFT		GH	◆	◆
32	K20.01342	0735 321 530		1	2.VİT.MASURA BİLYA	NEEDLE CAGE	75.0X83.0X35.0mm		◆	◆
33	K20.00699	1290 304 487		1	2.VİTES DİŞLİSİ	GEAR 2nd		ABCG	◆	◆
33	K20.00700	1290 304 485		1	2.VİTES DİŞLİSİ	GEAR 2nd		DEFH	◆	◆
34	K20.00701	1304 304 623	(1304 304 649)	2	1./2.VİT.SENKROMENÇ	ENGAGING RING			◆	◆
35	K20.00702	1290 304 350		2	1./2.VİT.SENK.FRENLEME	SYNCHRONIZING CONE			◆	◆
36	K20.00703	1290 304 366		2	1./2.VİT.SENK.FRENLEME	INTERMEDIATE CONE			◆	◆
37	K20.00704	1290 304 438	(1290 304 356)	2	1./2.VİT.SENK.FRENLEME	SYNCHRONIZING CONE			◆	◆
38	K20.00705	1304 304 687	(1304 304 645)	1	1./2.VİT.YILDIZ DİŞLİ	GUIDE SLEEVE			◆	◆
39	K20.00209	1312 304 159		3	1./2.VİT.YILDIZ DİŞ.BAKLASI	SLIDING BLOCK			◆	◆
40	K20.00110	0732 040 409		3	1./2.VİT.YILDIZ DİŞLİ YAYI	SPRING			◆	◆
41	K20.00111	1297 304 436		3	1./2.VİT.YILDIZ DİŞLİ FİŞEĞİ	PRESSURE PIECE			◆	◆
42	K20.00706	6002 305 994	(1290 304 440)	1	1./2.VİT.SENK.HALKA	ENGAGING SLEEVE			◆	◆
43	K20.00707	1290 306 439		2	1./2.VİTES HİLAL PABUCU	SLIDING PAD			◆	◆
44	K20.00708	1290 306 494	(1290 306 429)	1	1./2.VİTES HİLALİ	GEAR SHIFT FORK 1st/2nd			◆	◆
45	K20.01343	0735 321 531		2	1.VE GERİ VİT.MASURA BİLYA	NEEDLE CAGE	68.0X76.0X35.0mm		◆	◆
46	K20.00709	1290 304 572		1	1.VİTES DİŞLİSİ	GEAR 1st			◆	◆
47	K20.00710	1290 304 573		1	GERİ VİT.YILDIZ DİŞLİ	HUB			◆	◆
48	K20.00711	1290 304 058	(1290 304 371)	1	GERİ VİTES DİŞLİSİ 35 DİŞ	REVERSE GEAR			◆	◆
49	K20.00712	1290 206 164		1	GERİ VİTES HİLAL MİLİ	GEAR SHIFT RAIL			◆	◆
50	K20.00713	1290 306 295	(1290 306 078)	1	GERİ VİTES HİLALİ	GEAR SHIFT FORK / RG			◆	◆
51	K20.00714	1290 304 056		1	GERİ VİT.MAS.BİLYA ÇANAĞI	BEARING RACE			◆	◆
52	K20.01142	0750 116 373	(0735 330 615)	1	KAMALI MİL ARKA BİLYA	ROLLER BEARING	45.0X100.0X25.0mm		◆	◆
53		1290 201 211		1	ŞANZIMAN ORTA GÖVDE	HOUSING		A	◆	◆
53		1290 201 207		1	ŞANZIMAN ORTA GÖVDE	HOUSING		B	◆	◆
53		1290 201 191	(1290 201 180)	1	ŞANZIMAN ORTA GÖVDE	HOUSING		CDEF	◆	◆
53		1290 201 253		1	ŞANZIMAN ORTA GÖVDE	HOUSING		G	◆	◆
53		1290 201 256		1	ŞANZIMAN ORTA GÖVDE	HOUSING		H	◆	◆
54	K20.01027	0750 111 469	(0750 111 268)	1	ŞANZ.ARKA GÖVDE KEÇESİ	OIL SEAL	60.0X74.0X10.0mm		◆	◆
55	K20.00790	1290 304 599		1	ŞANZIMAN FLANŞI	COMPANION FLANGE	4-H, Ø150mm	ACDG	◆	◆
55	K20.00791	1290 304 580		1	ŞANZIMAN FLANŞI	COMPANION FLANGE	8-H, Ø150mm	B	◆	◆

NOTES :

ABCDEFHG alphabetic letters are used in conjunction with the encoded parts.
Alphabetical Coding has been done according to Input Shaft

NOTLAR :

ABCDEFHG alfabetik harfler ile kodlanan parçalar birlikte kullanılır.
Alfabetik kodlamalar prizdireklere göre yapılmıştır.

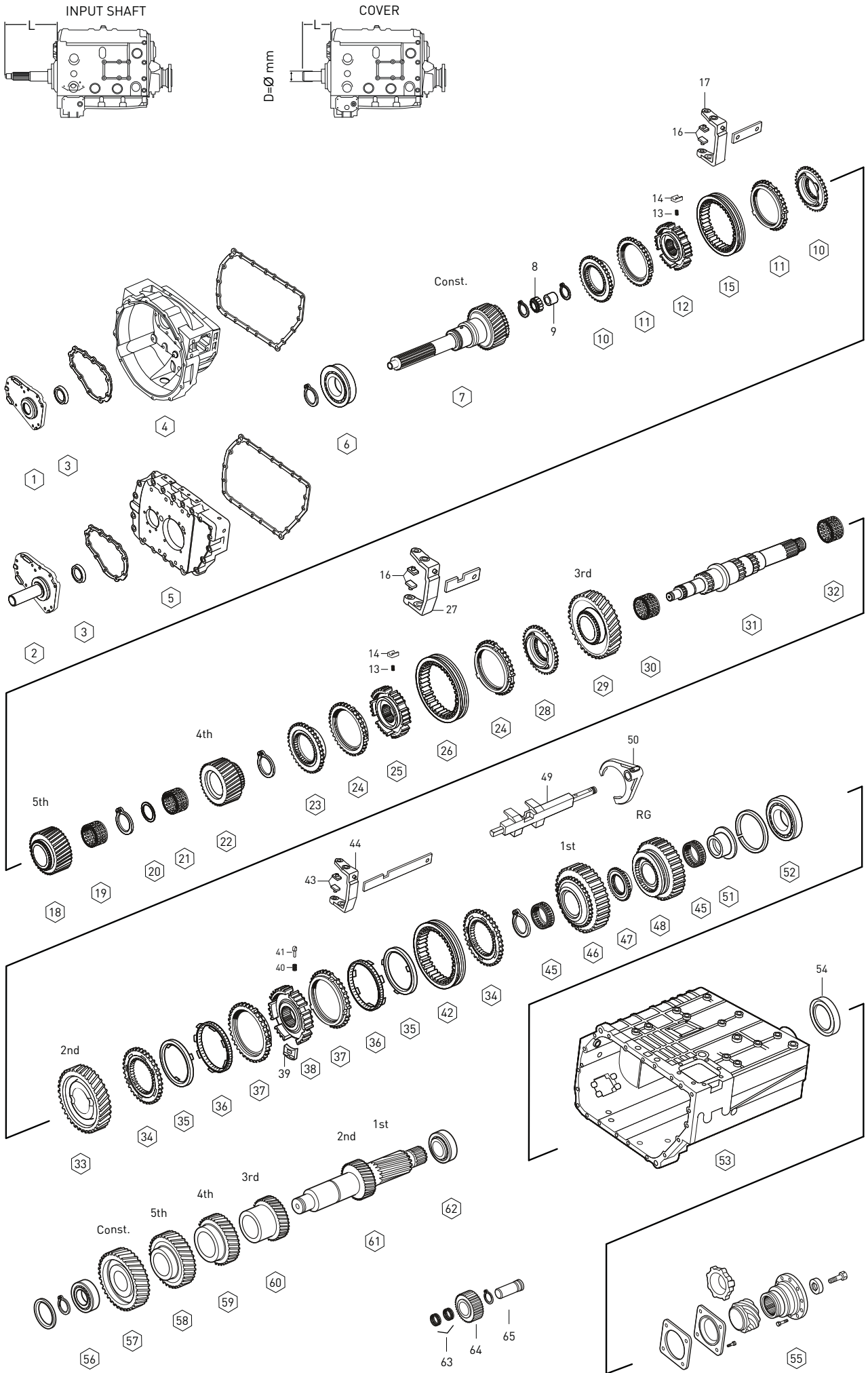

Fig.	Kacmaz No.	Oem No	Oem Old No	Pcs.	Ürün Tanımı	Description	Sizes	Notes	SG 6.72-0.79	DG 8.50-1.00
55	K20.00792	1290 304 598		1	ŞANZİMAN FLANŞI	COMPANION FLANGE	8-H, Ø175mm	EFH	◆	◆
56	K20.01143	0735 371 607	(0750 117 199)	1	GRUP MİLİ ÖN BİLYA	ROLLER BEARING	40.0X80.0X21.0mm		◆	◆
57	K20.00715	1290 303 200		1	PRİZDİREK KARŞ.36 DİŞ	CONST.GEAR 36 T		ABCG	◆	
57	K20.00716	1290 303 203		1	PRİZDİREK KARŞ.	CONST.GEAR		DEFH		◆
58	K20.00717	1290 303 199		1	5.VİTES DİŞLİ KARŞ.53 DİŞ	GEAR 5th 53 T		ABCG	◆	
58	K20.00718	1290 303 224	(1290 303 204)	1	5.VİTES DİŞLİ KARŞ.	GEAR 5th		DEFH		◆
59	K20.00719	1290 303 198		1	4.VİTES DİŞLİ KARŞ.31 DİŞ	GEAR 4th 31 T			◆	◆
60	K20.00720	1290 303 197		1	3.VİTES DİŞLİ KARŞ.22 DİŞ	GEAR 3rd 22 T		ABCG	◆	
60	K20.00721	1290 303 202		1	3.VİTES DİŞLİ KARŞ.	GEAR 3rd		DEFH		◆
61	K20.00722	1290 203 039	(1290 303 192)	1	GRUP MİLİ	COUNTER SHAFT		ABCG	◆	
61	K20.00723	1290 203 042		1	GRUP MİLİ	COUNTER SHAFT		DEFH		◆
62	K20.01144	0735 370 438		1	GRUP MİLİ ARKA BİLYA	ROLLER BEARING	39.6X76.2X23.8mm		◆	◆
63	K20.01344	0635 300 110		2	KÜÇÜK GERİ VİT.MAS.BİLYA	NEEDLE CAGE	28.0X35.0X18.0mm		◆	◆
64	K20.00724	1290 305 034	(1290 305 031)	1	KÜÇÜK GERİ VİTES	REV.IDLER GEAR			◆	◆
			(1290 305 029)							
			(1290 305 026)							
			(1290 305 023)							
65	K20.00725	1290 305 028	(1290 305 022)	1	KÜÇÜK GERİ VİTES PİMİ	PIN			◆	◆

NOTES :

ABCDEFGH alphabetic letters are used in conjunction with the encoded parts.
Alphabetical Coding has been done according to Input Shaft

NOTLAR :

ABCDEFGH alfabetik harfler ile kodlananparçalar birlikte kullanılır.
Alfabetik kodlamalar prizdireklere göre yapılmıştır.