

Fig.	Kacmaz No.	Oem No	Oem Old No	Pcs.	Ürün Tanımı	Description	Sizes	X1):6 S 1600 BD	X2):6 S 1601 BD IT	X3):6 S 1600-1700-1900 BO	X4):6 S 1701-1901 BO IT
1		1310 302 075		1	PRİZDİREK KEÇE KAPAĞI	COVER		◆	◆	◆	◆
2		0501 317 402		1	PRİZ.KEÇE KAPAK CONTASI	GASKET		◆	◆	◆	◆
3	K20.01003	0734 310 387		1	PRİZDİREK ÖN KEÇE	OIL SEAL	55x75x8mm	◆	◆	◆	◆
4		0730 002 660		1	PRİZDİREK ÖN BİLYA PULU	THRUST WASHER	1.20mm	◆	◆	◆	◆
4		0730 002 659		1	PRİZDİREK ÖN BİLYA PULU	THRUST WASHER	1.30mm	◆	◆	◆	◆
4		0730 002 658		1	PRİZDİREK ÖN BİLYA PULU	THRUST WASHER	1.40mm	◆	◆	◆	◆
4	K20.01724	0730 002 657		1	PRİZDİREK ÖN BİLYA PULU	THRUST WASHER	1.50mm	◆	◆	◆	◆
4		0730 002 656		1	PRİZDİREK ÖN BİLYA PULU	THRUST WASHER	1.60mm	◆	◆	◆	◆
4		0730 002 655		1	PRİZDİREK ÖN BİLYA PULU	THRUST WASHER	1.70mm	◆	◆	◆	◆
4		0730 002 654		1	PRİZDİREK ÖN BİLYA PULU	THRUST WASHER	1.80mm	◆	◆	◆	◆
4		0730 006 179		1	PRİZDİREK ÖN BİLYA PULU	THRUST WASHER	1.95mm	◆	◆	◆	◆
4		0730 006 180		1	PRİZDİREK ÖN BİLYA PULU	THRUST WASHER	2.00mm	◆	◆	◆	◆
4		0730 005 857		1	PRİZDİREK ÖN BİLYA PULU	THRUST WASHER	2.30mm	◆	◆	◆	◆
4		0730 008 568		1	PRİZDİREK ÖN BİLYA PULU	THRUST WASHER	2.50mm	◆	◆	◆	◆
4		0730 008 576		1	PRİZDİREK ÖN BİLYA PULU	THRUST WASHER	2.90mm	◆	◆	◆	◆
5		1310 302 102		1	YAĞLAMA SACI	RING		◆	◆	◆	◆
6	K20.00938	1310 201 044	(1310 201 045)	1	ŞANZIMAN ÖN GÖVDE	HOUSING		◆	◆	◆	◆
7		0630 513 015		1	PRİZDİREK ÖN BİLYA SEKMANI	RETAINING RING		◆	◆	◆	◆
8		1310 202 001		1	PRİZDİREK YAĞLAMA PİPETİ	RING		◆	◆	◆	◆
9	K20.01151	0750 117 518		2	PRİZ.ÖN VE K.MİL ARKA BİLYA	ROLLER BEARING	71.40x120.0x32.50mm	◆	◆	◆	◆
10	K20.01913	1310 302 088		1	PRİZDİREK 27 DİŞ	INPUT SHAFT 27 T		◆	◆		
10	K20.00947	1310 302 089		1	PRİZDİREK 31 DİŞ	INPUT SHAFT 31 T				◆	◆
11	K20.10003	1310 302 045	(1310 304 160)	1	PRİZDİREK SENKROMENÇ	ENGAGING RING		◆	◆	◆	◆
12		0501 315 236		1	PRİZDİREK KİL KEÇE	DIAPHRAGM		◆	◆	◆	◆
13	K20.01109	0750 117 232	(0735 371 563)	1	KAMALI MİL UÇ BİLYA	NEEDLE BEARING	42.0x40.30mm	◆	◆	◆	◆
14		0630 501 069		1	KAMALI MİL UÇ BİLYA SEK.	RETAINING RING	2.20mm	◆	◆	◆	◆
14		0630 501 068		1	KAMALI MİL UÇ BİLYA SEK.	RETAINING RING	2.30mm	◆	◆	◆	◆
14		0630 501 067		1	KAMALI MİL UÇ BİLYA SEK.	RETAINING RING	2.40mm	◆	◆	◆	◆
14		0630 531 141		1	KAMALI MİL UÇ BİLYA SEK.	RETAINING RING	2.50mm	◆	◆	◆	◆
15	K20.00781	1268 304 594	(1268 304 445)	2	5./6.VİTES SENK.FRENLEME	SYNCHRONIZING CONE		◆	◆	◆	◆
16	K20.00943	1310 304 158		1	5./6.VİTES SENK.YILDIZ DİŞLİ	GUIDE SLEEVE		◆	◆	◆	◆
17	K20.00110	0732 040 409		9	YILDIZ DİŞLİ YAYI	SPRING		◆	◆	◆	◆
18	K20.00111	1297 304 436		9	YILDIZ DİŞLİ FİŞEĞİ	PRESSURE PIECE		◆	◆	◆	◆
19	K20.01745	1295 298 956		kit	YILDIZ DİŞLİ YAY FİŞEK TAKIMI	REPAIR KIT		◆	◆	◆	◆
20	K20.00951	1310 304 195		1	5./6.VİTES SENK.HALKA	ENGAGING SLEEVE		◆	◆	◆	◆
21	K20.00169	1290 306 066		6	HİLAL PABUCU	SLIDING PAD		◆	◆	◆	◆
22		1310 206 085		1	5./6.VİTES HİLALİ	GEAR SHIFT FORK 5th/6th		◆	◆		
22		1310 206 081		1	5./6.VİTES HİLALİ	GEAR SHIFT FORK 5th/6th				◆	◆
23	K20.00952	1310 304 161		1	5.VİTES SENKROMENÇ	SYNCHRONIZING RING		◆	◆	◆	◆
24	K20.01817	1310 304 137		1	5.VİTES DİŞLİSİ 27 DİŞ	GEAR 5th 27 T		◆	◆		
24	K20.00942	1310 304 138		1	5.VİTES DİŞLİSİ 23 DİŞ	GEAR 5th 23 T				◆	◆

## NOTES :

X1,X2,X3,X4 are used in conjunction with the encoded parts.

## NOTLAR :

X1,X2,X3,X4 ile kodlanan parçalar birlikte kullanılır.

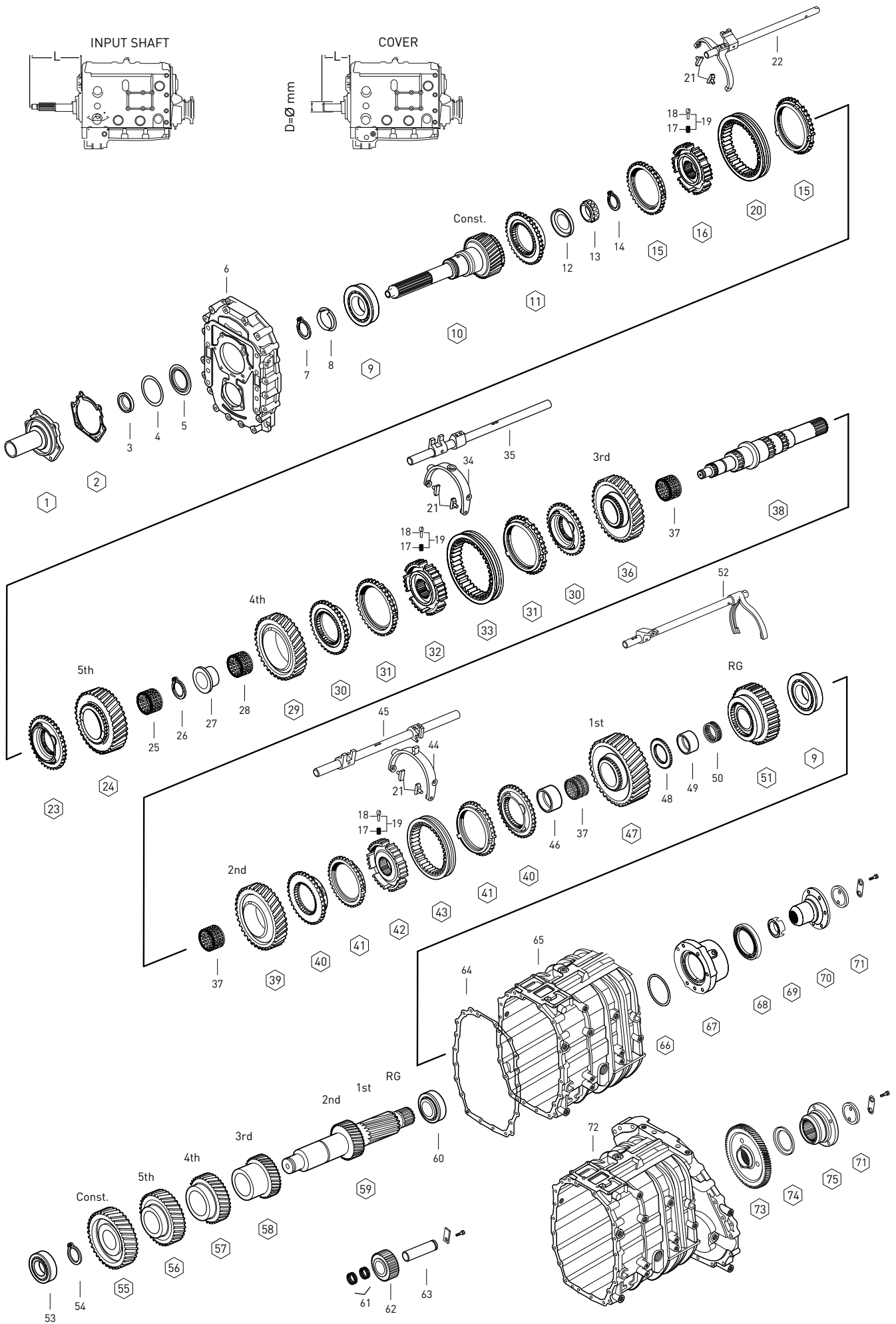

Fig.	Kacmaz No.	Oem No	Oem Old No	Pcs.	Ürün Tanımı	Description	Sizes	[X1]:6 S 1600 BD	[X2]:6 S 1601 BD IT	[X3]:6 S 1600-1700-1900 BO	[X4]:6 S 1701-1901 BO IT
25		0735 321 560	(0750 115 580)	1	5.VİTES MASURA BİLYA	NEEDLE CAGE		◆	◆	◆	◆
26		0730 501 729		1	4./5.VİTES AYAR SEKMANI	RETAINING RING	3.70mm	◆	◆	◆	◆
26		0730 501 730		1	4./5.VİTES AYAR SEKMANI	RETAINING RING	3.80mm	◆	◆	◆	◆
26		0730 501 731		1	4./5.VİTES AYAR SEKMANI	RETAINING RING	3.90mm	◆	◆	◆	◆
26		0730 501 732		1	4./5.VİTES AYAR SEKMANI	RETAINING RING	4.00mm	◆	◆	◆	◆
27	K20.00969	0730 162 753		1	4.VİTES MAS.BİLYA ÇANAĞI	BEARING RACE		◆	◆	◆	◆
28		0735 321 392		1	4.VİTES MASURA BİLYA	NEEDLE CAGE	85.0X93.0X44.0mm	◆	◆	◆	◆
29	K20.01818	1310 304 177		1	4 VİTES DİŞLİSİ 28 DİŞ	GEAR 4th 28 T		◆	◆		
29	K20.00941	1310 304 178		1	4 VİTES DİŞLİSİ 28 DİŞ	GEAR 4th 28 T				◆	◆
30	K20.00937	1310 304 232		2	3./4.VİTES SENKROMENÇ	SYNCHRONIZING RING		◆	◆	◆	◆
31	K20.00108	1297 304 484	(1297 304 402)	2	3./4.VİTES SENK.FRENLEME	SYNCHRONIZING CONE		◆	◆	◆	◆
32	K20.00181	1312 304 052		1	3./4.VİTES YILDIZ DİŞLİ	GUIDE SLEEVE		◆	◆	◆	◆
33	K20.00103	1316 304 167	(1315 304 135)	1	3./4.VİTES SENK.HALKA	ENGAGING SLEEVE		◆	◆	◆	◆
34		1310 306 051		1	3./4.VİTES HİLALİ	GEAR SHIFT FORK 3rd/4th		◆	◆	◆	◆
35		1310 206 084		1	3./4.VİTES HİLAL MİLİ	SELECTOR ROD 3rd/4th		◆	◆		
35		1310 206 079		1	3./4.VİTES HİLAL MİLİ	SELECTOR ROD 3rd/4th				◆	◆
36	K20.01914	1310 304 185		1	3.VİTES DİŞLİSİ 33 DİŞ	GEAR 3rd 33 T		◆	◆		
36	K20.01915	1310 304 186		1	3.VİTES DİŞLİSİ 34 DİŞ	GEAR 3rd 34 T				◆	◆
37		0735 321 432		3	1./2./3.VİTES MASURA BİLYA	NEEDLE CAGE	92.0x100.0x49.50mm	◆	◆	◆	◆
38	K20.00946	1310 304 189		1	KAMALI MİL	MAIN SHAFT		◆	◆	◆	◆
39	K20.01916	1310 304 196		1	2.VİTES DİŞLİSİ 43 DİŞ	GEAR 2nd 43 T		◆	◆	◆	◆
40	K20.00182	1313 304 009		2	1./2.VİTES SENKROMENÇ	ENGAGING RING		◆	◆	◆	◆
41	K20.00112	1297 304 485	(1297 304 401)	2	1./2.VİTES SENK.FRENLEME	SYNCHRONIZING CONE		◆	◆	◆	◆
42	K20.00179	1313 304 008		1	1./2.VİTES YILDIZ DİŞLİ	GUIDE SLEEVE		◆	◆	◆	◆
43	K20.00115	1316 304 078		1	1./2.VİTES SENK.HALKA	ENGAGING SLEEVE		◆	◆	◆	◆
44		1310 306 052		1	1./2.VİTES HİLALİ	GEAR SHIFT FORK 1st/2nd		◆	◆	◆	◆
45		1310 206 083		1	1./2.VİTES HİLAL MİLİ	SELECTOR ROD 1st/2nd		◆	◆		
45		1310 206 078		1	1./2.VİTES HİLAL MİLİ	SELECTOR ROD 1st/2nd				◆	◆
46	K20.02078	0735 295 148		1	1.VİTES MAS.BİLYA ÇANAĞI	BEARING RACE	80.50x92.0x49.50mm	◆	◆	◆	◆
47	K20.00955	1310 304 182		1	1.VİTES DİŞLİSİ 50 DİŞ	GEAR 1st 50 T		◆	◆	◆	◆
48	K20.00950	1310 304 188		1	GERİ VİTES YILDIZ DİŞLİ	HUB		◆	◆	◆	◆
49	K20.02079	0750 119 131		1	GERİ VİT.MAS.BİLYA ÇANAĞI	BEARING RACE		◆	◆	◆	◆
50		0735 321 394		1	GERİ VİTES MASURA BİLYA	NEEDLE CAGE	82.0x90.0x47.0mm	◆	◆	◆	◆
51	K20.00957	1310 304 201		1	GERİ VİTES DİŞLİSİ 46 DİŞ	REVERSE GEAR 46 T		◆	◆	◆	◆
52		1310 206 082		1	GERİ VİTES HİLALİ	GEAR SHIFT FORK RG		◆	◆		
52		1310 206 077		1	GERİ VİTES HİLALİ	GEAR SHIFT FORK RG				◆	◆
53	K20.01123	0750 117 083		1	GRUP MİLİ ÖN BİLYA	ROLLER BEARING	50.80x95.20x27.70mm	◆	◆	◆	◆
54		0630 501 373		1	GRUP MİLİ ÖN BİLYA SEKMANI	RETAINING RING	1.80mm	◆	◆	◆	◆
54		0630 501 366		1	GRUP MİLİ ÖN BİLYA SEKMANI	RETAINING RING	1.90mm	◆	◆	◆	◆
54		0630 501 363		1	GRUP MİLİ ÖN BİLYA SEKMANI	RETAINING RING	2.00mm	◆	◆	◆	◆
54		0630 501 364		1	GRUP MİLİ ÖN BİLYA SEKMANI	RETAINING RING	2.10mm	◆	◆	◆	◆

## NOTES :

X1,X2,X3,X4 are used in conjunction with the encoded parts.

## NOTLAR :

X1,X2,X3,X4 ile kodlanan parçalar birlikte kullanılır.

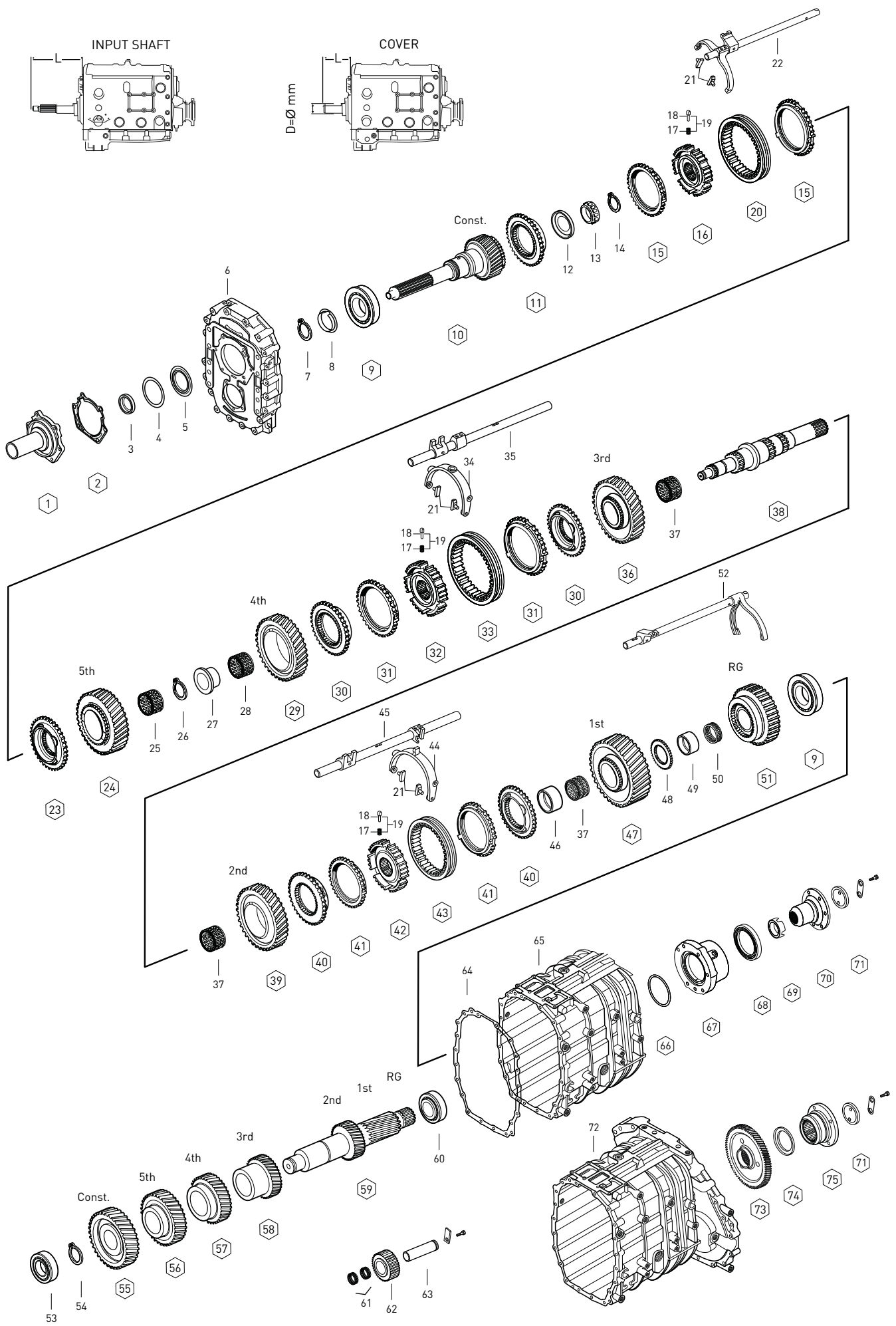



Fig.	Kacmaz No.	Oem No	Oem Old No	Pcs.	Ürün Tanımı	Description	Sizes	X1: 6 S 1600 BD	X2: 6 S 1601 BD IT	X3: 6 S 1600-1700-1900 BO	X4: 6 S 1701-1901 BO IT
54		0630 501 365		1	GRUP MİLİ ÖN BİLYA SEKMANI	RETAINING RING	2.20mm	◆	◆	◆	◆
54		0630 501 189		1	GRUP MİLİ ÖN BİLYA SEKMANI	RETAINING RING	2.30mm	◆	◆	◆	◆
54		0630 501 190		1	GRUP MİLİ ÖN BİLYA SEKMANI	RETAINING RING	2.40mm	◆	◆	◆	◆
54		0630 501 047		1	GRUP MİLİ ÖN BİLYA SEKMANI	RETAINING RING	2.50mm	◆	◆	◆	◆
55	K20.01816	1310 303 068		1	PRİZDİREK KARŞILIĞI 50 DİŞ	CONSTANT GEAR 50 T		◆	◆		
55	K20.00958	1310 303 069		1	PRİZDİREK KARŞILIĞI 47 DİŞ	CONSTANT GEAR 47 T				◆	◆
56	K20.00954	1310 303 074		1	5.VİTES DİŞLİ KARŞILIĞI 39 DİŞ	GEAR 5th 39 T		◆	◆		
56	K20.01917	1310 303 079		1	5.VİTES DİŞLİ KARŞILIĞI 43 DİŞ	GEAR 5th 43 T				◆	◆
57	K20.00953	1310 303 075		1	4.VİTES DİŞLİ KARŞILIĞI 29 DİŞ	GEAR 4th 29 T		◆	◆		
57	K20.01918	1310 303 083		1	4.VİTES DİŞLİ KARŞILIĞI 31 DİŞ	GEAR 4th 31 T				◆	◆
58	K20.01815	1310 303 073		1	3.VİTES DİŞLİ KARŞILIĞI 23 DİŞ	GEAR 3rd 23 T		◆	◆		
58	K20.01919	1310 303 078		1	3.VİTES DİŞLİ KARŞILIĞI 24 DİŞ	GEAR 3rd 24 T				◆	◆
59	K20.01820	1310 303 053		1	GRUP MİLİ 12-18 DİŞ	COUNTER SHAFT 12-18 T		◆	◆	◆	◆
60	K20.01146	0735 300 511	{1246 203 008}	1	GRUP MİLİ ARKA BİLYA	ROLLER BEARING	44.45x95.25x27.78mm	◆	◆	◆	◆
			{0635 501 398}								
61		0750 115 233		2	KÜÇÜK GERİ VİT.MAS.BİLYA	NEEDLE CAGE	30.0x38.0x30.0mm	◆	◆	◆	◆
62	K20.01920	1310 305 011		1	KÜÇÜK GERİ VİTES 21 DİŞ	REV.IDLER GEAR 21 T		◆	◆	◆	◆
63		1310 305 001		1	KÜÇÜK GERİ VİTES PİMİ	PIN		◆	◆	◆	◆
64		1310 301 059		1	ŞANZ. ORTA GÖVDE CONTASI	GASKET		◆	◆	◆	◆
65		1310 201 012		1	ŞANZIMAN ORTA GÖVDE	HOUSING		◆		◆	
66		0634 313 100		1	ŞANZ.ARKA KAPAK ORİNGİ	O-RING	113x3mm	◆		◆	
67		1310 301 057		1	ŞANZ.ARKA KEÇE KAPAĞI	COVER		◆		◆	
68		0734 319 513		1	ŞANZ.ARKA KAPAK KEÇESİ	OIL SEAL	85x105x12mm	◆		◆	
69		1310 204 018		1	ŞANZ.KM.DEVİR SACI	PULSE STAR		◆		◆	
70		1310 343 027		1	ŞANZIMAN FLANŞI	OUTPUT FLANGE		◆		◆	
71		1259 303 004		1	ŞANZ.FLANŞI ALIN PULU	THRUST WASHER		◆		◆	
72		6085 301 160		1	ŞANZIMAN ORTA GÖVDE	HOUSING	RETARDER		◆		◆
73	K20.01921	6085 301 091		1	RETARDER DİŞLİSİ	ENGAGING RING	RETARDER		◆		◆
74		1310 304 193		1	ŞANZ.FLANŞ EMNİYET SACI	DUST COVER			◆		◆
75		1310 304 162		1	ŞANZIMAN FLANŞI	OUTPUT FLANGE			◆		◆

**NOTES :**

X1,X2,X3,X4 are used in conjunction with the encoded parts.

**NOTLAR :**

X1,X2,X3,X4 ile kodlanan parçalar birlikte kullanılır.

SYNCHRONIZER KIT 5th/6th

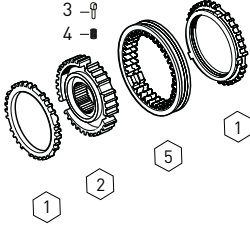

Fig.	Kacmaz No.	Oem No	Oem Old No	Pcs.	Ürün Tanımı	Description
	K20.01874	1310 204 016		Kit	5./6.VİT.SENKROMENÇ KİTİ	SYNCH.KIT 5th/6th
1	K20.00781	1268 304 594	(1268 304 445)	2	5./6.VİT.SENK.FRENLEME	SYNCHRONIZING CONE
2	K20.00943	1310 304 158		1	5./6.VİT.YILDIZ DİŞLİ	GUIDE SLEEVE
3	K20.00111	1297 304 436		3	PRİZ.YILDIZ DİŞLİ FİŞEĞİ	PRESSURE PIECE
4	K20.00110	0732 040 409		3	PRİZ.YILDIZ DİŞLİ YAYI	SPRING
5	K20.00951	1310 304 195		1	5./6.VİT.SENK.HALKA	ENGAGING SLEEVE

SYNCHRONIZER KIT 5th/6th

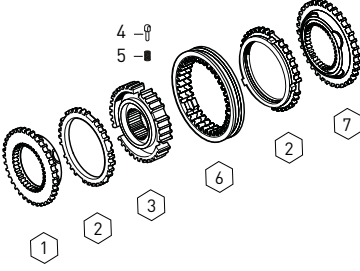

Fig.	Kacmaz No.	Oem No	Oem Old No	Pcs.	Ürün Tanımı	Description
	K20.01872	2001872		Kit	5./6.VİT.SENKROMENÇ KİTİ	SYNCH.KIT 5th/6th
1	K20.10003	1310 302 045	(1310 304 160)	1	PRİZDİREK SENKROMENÇ	ENGAGING RING
2	K20.00781	1268 304 594	(1268 304 445)	2	5./6.VİT.SENK.FRENLEME	SYNCHRONIZING CONE
3	K20.00943	1310 304 158		1	5./6.VİT.YILDIZ DİŞLİ	GUIDE SLEEVE
4	K20.00111	1297 304 436		3	PRİZ.YILDIZ DİŞLİ FİŞEĞİ	PRESSURE PIECE
5	K20.00110	0732 040 409		3	PRİZ.YILDIZ DİŞLİ YAYI	SPRING
6	K20.00951	1310 304 195		1	5./6.VİT.SENK.HALKA	ENGAGING SLEEVE
7	K20.00952	1310 304 161		1	5.VİTES SENKROMENÇ	ENGAGING RING

SYNCHRONIZER KIT 5th/6th

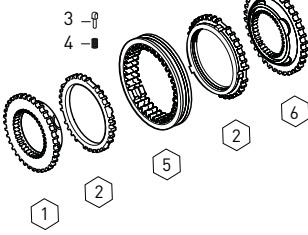

Fig.	Kacmaz No.	Oem No	Oem Old No	Pcs.	Ürün Tanımı	Description
	K20.01873	2001873		Kit	5./6.VİT.SENKROMENÇ KİTİ	SYNCH.KIT 5th/6th
1	K20.10003	1310 302 045	(1310 304 160)	1	PRİZDİREK SENKROMENÇ	ENGAGING RING
2	K20.00781	1268 304 594	(1268 304 445)	2	5./6.VİT.SENK.FRENLEME	SYNCHRONIZING CONE
3	K20.00111	1297 304 436		3	PRİZ.YILDIZ DİŞLİ FİŞEĞİ	PRESSURE PIECE
4	K20.00110	0732 040 409		3	PRİZ.YILDIZ DİŞLİ YAYI	SPRING
5	K20.00951	1310 304 195		1	5./6.VİT.SENK.HALKA	ENGAGING SLEEVE
6	K20.00952	1310 304 161		1	5.VİTES SENKROMENÇ	ENGAGING RING

SYNCHRONIZER KIT 3rd/4th

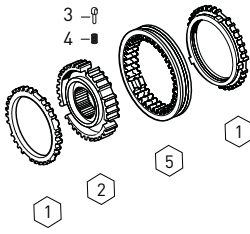

Fig.	Kacmaz No.	Oem No	Oem Old No	Pcs.	Ürün Tanımı	Description
	K20.01875	1349 204 001		Kit	3./4.VİT.SENKROMENÇ KİTİ	SYNCH.KIT 3rd/4th
1	K20.00108	1297 304 484	(1297 304 402)	2	3./4.VİT.SENK.FRENLEME	SYNCHRONIZING CONE
2	K20.00181	1312 304 052		1	3./4.VİT.YILDIZ DİŞLİ	GUIDE SLEEVE
3	K20.00111	1297 304 436		3	PRİZ.YILDIZ DİŞLİ FİŞEĞİ	PRESSURE PIECE
4	K20.00110	0732 040 409		3	PRİZ.YILDIZ DİŞLİ YAYI	SPRING
5	K20.00103	1316 304 167	(1315 304 135)	1	3./4.VİT.SENK.HALKA	ENGAGING SLEEVE

SYNCHRONIZER KIT 3rd/4th

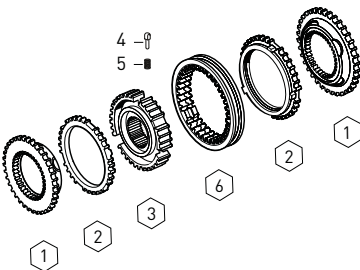

Fig.	Kacmaz No.	Oem No	Oem Old No	Pcs.	Ürün Tanımı	Description
	K20.01876	2001876		Kit	3./4.VİT.SENKROMENÇ KİTİ	SYNCH.KIT 3rd/4th
1	K20.00937	1310 304 232		2	3./4.VİT.SENKROMENÇ	ENGAGING RING
2	K20.00108	1297 304 484	(1297 304 402)	2	3./4.VİT.SENK.FRENLEME	SYNCHRONIZING CONE
3	K20.00181	1312 304 052		1	3./4.VİT.YILDIZ DİŞLİ	GUIDE SLEEVE
4	K20.00111	1297 304 436		3	3./4.VİT.YILDIZ DİŞLİ FİŞEĞİ	PRESSURE PIECE
5	K20.00110	0732 040 409		3	3./4.VİT.YILDIZ DİŞLİ YAYI	SPRING
6	K20.00103	1316 304 167	(1315 304 135)	1	3./4.VİT.SENK.HALKA	ENGAGING SLEEVE

Fig.	Kacmaz No.	Oem No	Oem Old No	Pcs.	Ürün Tanımı	Description
	K20.01877	2001877		Kit	3./4.VİT.SENKROMENÇ KİTİ	SYNCH.KIT 3rd/4th
1	K20.00937	1310 304 232		1	3./4.VİT.SENKROMENÇ	ENGAGING RING
2	K20.00108	1297 304 484	[1297 304 402]	2	3./4.VİT.SENK.FRENLEME	SYNCHRONIZING CONE
3	K20.00111	1297 304 436		3	3./4.VİT.YILDIZ DİŞLİ FİŞEĞİ	PRESSURE PIECE
4	K20.00110	0732 040 409		3	3./4.VİT.YILDIZ DİŞLİ YAYI	SPRING
5	K20.00103	1316 304 167	[1315 304 135]	1	3./4.VİT.SENK.HALKA	ENGAGING SLEEVE

SYNCHRONIZER KIT 3rd/4th

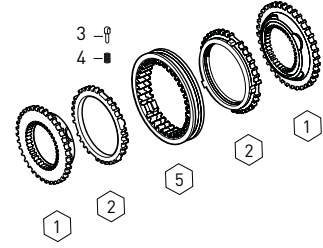

Fig.	Kacmaz No.	Oem No	Oem Old No	Pcs.	Ürün Tanımı	Description
	K20.00526	1313 204 003		Kit	1./2.VİT.SENKROMENÇ KİT	SYNCH.KIT 1st/2nd
1	K20.00112	1297 304 485	[1297 304 401]	2	1./2.VİT.FRENLEME	SYNCH.CONE
2	K20.00179	1313 304 008		1	1./2.VİT.YILDIZ DİŞLİ	GUIDE SLEEVE
3	K20.00111	1297 304 436		3	1./2.VİT.YILDIZ DİŞLİ FİŞEĞİ	PRESSURE PIECE
4	K20.00110	0732 040 409		3	1./2.VİT.YILDIZ DİŞLİ YAYI	SPRING
5	K20.00115	1316 304 078		1	1./2.VİT.SENK.HALKA	ENGAGING SLEEVE

SYNCHRONIZER KIT 1st/2nd

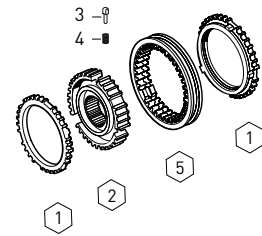

Fig.	Kacmaz No.	Oem No	Oem Old No	Pcs.	Ürün Tanımı	Description
	K20.00527	1313 298 909		Kit	1./2.VİT.SENKROMENÇ KİT	SYNCH.KIT 1st/2nd
1	K20.00182	1313 304 009		2	1./2.VİT.SENKROMENÇ	ENGAGING RING
2	K20.00112	1297 304 485	[1297 304 401]	2	1./2.VİT.FRENLEME	SYNCH.CONE
3	K20.00179	1313 304 008		1	1./2.VİT.YILDIZ DİŞLİ	GUIDE SLEEVE
4	K20.00111	1297 304 436		3	1./2.VİT.YILDIZ DİŞLİ FİŞEĞİ	PRESSURE PIECE
5	K20.00110	0732 040 409		3	1./2.VİT.YILDIZ DİŞLİ YAYI	SPRING
6	K20.00115	1316 304 078		1	1./2.VİT.SENK.HALKA	ENGAGING SLEEVE

SYNCHRONIZER KIT 1st/2nd

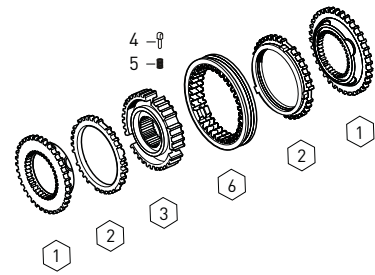

Fig.	Kacmaz No.	Oem No	Oem Old No	Pcs.	Ürün Tanımı	Description
	K20.01878	1313 298 911		Kit	1./2.VİT.SENKROMENÇ KİT	SYNCH.KIT 1st/2nd
1	K20.00182	1313 304 009		2	1./2.VİT.SENKROMENÇ	ENGAGING RING
2	K20.00112	1297 304 485	[1297 304 401]	2	1./2.VİT.FRENLEME	SYNCH.CONE
3	K20.00115	1316 304 078		1	1./2.VİT.SENK.HALKA	ENGAGING SLEEVE
4	K20.00111	1297 304 436		3	1./2.VİT.YILDIZ DİŞLİ FİŞEĞİ	PRESSURE PIECE
5	K20.00110	0732 040 409		3	1./2.VİT.YILDIZ DİŞLİ YAYI	SPRING

SYNCHRONIZER KIT 1st/2nd

