

Fig. Kacmaz No.	Oem No	Oem Old No	Pcs.	Ürün Tanımı	Description	Sizes	X1 : 1268 008 605	X2 : 1268 008 607	X3 : 1268 008 624
1	0091 302 098		1	PRİZDİREK KEÇE KAPAĞI	COVER		◆		
1	0091 302 111		1	PRİZDİREK KEÇE KAPAĞI	COVER			◆	
1	0091 302 108		1	PRİZDİREK KEÇE KAPAĞI	COVER				◆
2	0734 310 111		1	PRİZDİREK KEÇESİ	OIL SEAL	55.0X75.0X8.0mm	◆	◆	
2	0734 310 108		1	PRİZDİREK KEÇESİ	OIL SEAL	48.0X69.0X10.0mm			◆
3	1250 302 478		1	PRİZ.KEÇE KAPAK CONTASI	GASKET		◆	◆	◆
4	1205 308 016		1	PRİZDİREK PULU	THRUST WASHER	0.20mm	◆	◆	◆
4	1205 308 020		1	PRİZDİREK PULU	THRUST WASHER	0.30mm	◆	◆	◆
5	0730 361 046		1	EMNİYET SACI	SPACER RING		◆	◆	◆
6	0730 102 632		2	PARÇALI KİLİT	SPLIT RING	6.70mm	◆	◆	◆
6	0730 103 510		2	PARÇALI KİLİT	SPLIT RING	7.20mm	◆	◆	◆
7	K20.02121 0630 503 020		2	PRİZ.ÖN BİLYA KİLİT SEKMANI	LOCK RING		◆	◆	◆
8	0750 118 082		2	PRİZ.ÖN VE ARKA KUTU BİLYASI	ROLLER BEARING	70.0X150.0X35.0mm	◆	◆	◆
9	K20.01807 0091 302 097		1	PRİZDİREK 28 DİŞ	INPUT SHAFT 28 T		◆		
9	K20.01898 0091 302 110		1	PRİZDİREK 28 DİŞ	INPUT SHAFT 28 T			◆	
9	K20.01899 1268 302 175		1	PRİZDİREK 28 DİŞ	INPUT SHAFT 28 T				◆
10	0630 501 024		1	PRİZDİREK MASURA BİLA PULU	SEEGER RING	1.50mm	◆	◆	◆
11	K20.01153 0735 455 012		1	PRİZDİREK MASURA BİLYA	NEEDLE CAGE	30.0X68.0X26.0mm	◆	◆	◆
12	0630 501 195		1	PRİZ.MASURA BİLYA SEKMANI	RETAINING RING	2.80mm	◆	◆	◆
13	0730 002 684		1	PRİZDİREK RAYNELİ	SHIM	3.00mm	◆	◆	◆
14	K20.01900 0091 302 152		1	PRİZDİREK SENKROMENÇ	ENGAGING RING		◆	◆	◆
15	K20.00781 1268 304 594	(1268 304 445)	4	PRİZ./5./4./3.VİT.SENK.FRENLEME	SYNCHRONIZING CONE		◆	◆	◆
16	K20.01901 1268 304 554		1	PRİZ.-5.VİT.YILDIZ DİŞLİ	GUIDE SLEEVE		◆	◆	◆
17	K20.00110 0732 040 409		3	PRİZ./5./4./3.VİT.YİL.DİŞLİ YAYI	SPRING		◆	◆	◆
18	K20.00111 1297 304 436		3	PRİZ./5./4./3.VİT.YİL.DİŞLİ FİŞEĞİ	PRESSURE PIECE		◆	◆	◆
19	K20.00255 1304 304 597	(1304 304 541)	2	PRİZ./5./4./3.VİT.SENK.HALKA	ENGAGING SLEEVE		◆	◆	◆
20	1250 306 262		1	4./5.VİTES HİLALİ	G.SHIFT FORK 4th/5th		◆	◆	◆
21	1268 306 101		6	HİLAL PABUCU	SLIDING PAD		◆	◆	◆
22	0730 300 005		8	HİLAL VİDA PULU	WASHER		◆	◆	◆
23	1252 306 077		8	HİLAL VİDASI	SCREW		◆	◆	◆
24	K20.01811 0091 304 202		1	5.VİTES SENKROMENÇ	ENGAGING RING		◆	◆	◆
25	K20.01902 1268 304 559		1	5.VİTES DİŞLİSİ 31 DİŞ	GEAR 5th 31 T		◆	◆	◆
26	0735 320 837		1	5.VİTES DİŞLİSİ MASURA BİLYA	NEEDLE CAGE		◆	◆	◆
27	1268 304 562		1	4.VİTES DİŞLİ BURCU	BUSHING		◆	◆	◆
28	K20.01903 0091 304 054		1	4.VİTES DİŞLİSİ 31 DİŞ	GEAR 4th 31 T		◆	◆	◆
29	0735 320 407		1	4.VİTES DİŞLİSİ MASURA BİLYA	NEEDLE CAGE	58.0X65.0X36.0mm	◆	◆	◆
30	K20.01812 0091 304 062		2	3./4.VİTES SENKROMENÇ	ENGAGING RING		◆	◆	◆
31	0630 501 181		1	3./4.VİTES YILDIZ DİŞLİ SEK.	SEEGER RING	2.40mm	◆	◆	◆
31	0630 501 153		1	3./4.VİTES YILDIZ DİŞLİ SEK.	SEEGER RING	2.70mm	◆	◆	◆
32	K20.01904 1268 304 555		1	3./4.VİTES YILDIZ DİŞLİ	GUIDE SLEEVE		◆	◆	◆
33	1246 206 011		1	2./3.VİTES HİLALİ	G.SHIFT FORK 2nd/3rd		◆	◆	◆

NOTES :

X1,X2,X3 are used in conjunction with the encoded parts.

NOTLAR :

X1,X2,X3 ile kodlanan parçalar birlikte kullanılır.

6 S 1550

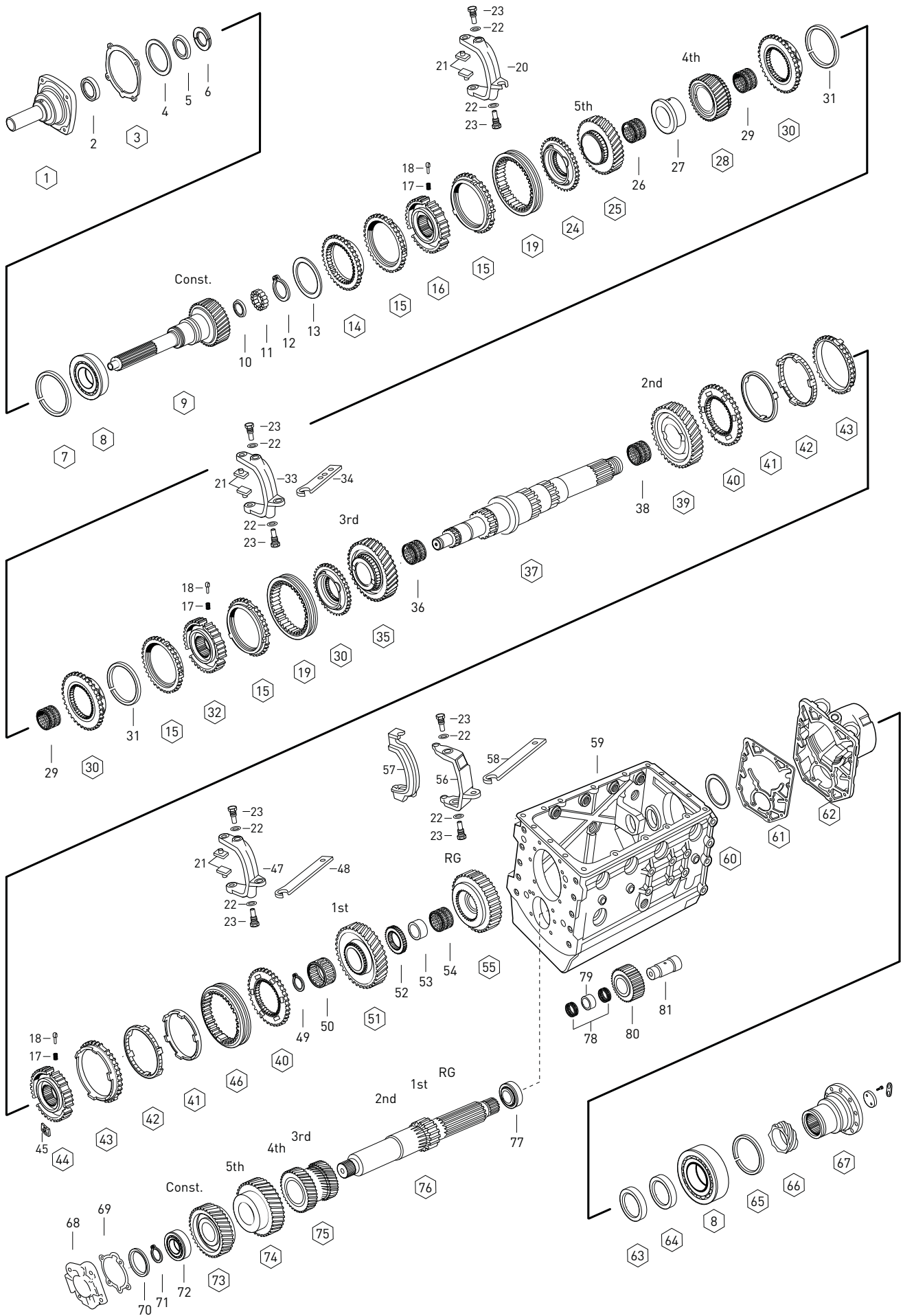

Fig. Kacmaz No.	Oem No	Oem Old No	Pcs.	Ürün Tanımı	Description	Sizes	[X1] :1268 008 605	[X2] :1268 008 607	[X3] :1268 008 624	
34		1240 306 229		1	2./3.VİTES HİLAL ÇİTASI	SELECTOR ROD		◆	◆	◆
35	K20.01798	0091 304 061		1	3.VİTES DIŞLİSİ 35 DİŞ	GEAR 3rd 35 T		◆	◆	◆
36		0735 320 471		1	3.VİTES DIŞLİSİ MASURA BİLYA	NEEDLE CAGE		◆	◆	◆
37	K20.01802	0091 304 328	(1268 304 553)	1	KAMALI MİL	MAIN SHAFT		◆	◆	◆
38		0501 398 351		1	2.VİTES DIŞLİSİ MASURA BİLYA	NEEDLE CAGE		◆	◆	◆
39	K20.01905	1268 304 566		1	2.VİTES DIŞLİSİ 42 DİŞ	GEAR 2nd 42 T		◆		◆
39	K20.01906	1268 304 175		1	2.VİTES DIŞLİSİ	GEAR 2nd			◆	
40	K20.00143	1312 304 106		2	1./2.VİTES SENKROMENÇ	ENGAGING RING		◆	◆	◆
41	K20.00144	1268 304 424		2	1./2.VİTES SENK.FRENLEME	SYNCHRONIZING CONE		◆	◆	◆
42	K20.00302	1268 304 494	(1268 304 491)	2	1./2.VİTES SENK.FRENLEME	INTERMEDIATE CONE		◆	◆	◆
43	K20.00145	1268 304 525		2	1./2.VİTES SENK.FRENLEME	SYNCHRONIZING CONE		◆	◆	◆
44	K20.01908	1268 304 557		1	1./2.VİTES YILDIZ DİŞLİ	GUIDE SLEEVE		◆	◆	◆
45	K20.00209	1312 304 159		3	1./2.VİTES YILDIZ DİŞLİ BAKLASI	SLIDING BLOCK		◆	◆	◆
46	K20.00147	1310 304 175	(1312 304 157)	1	1./2.VİTES SENK.HALKA	ENGAGING SLEEVE		◆	◆	◆
47		0091 206 005		1	1.VİTES HİLALİ	G.SHIFT FORK 1st		◆	◆	◆
48		1268 306 096		1	1.VİTES HİLAL ÇİTASI	SELECTOR ROD		◆	◆	◆
49		0630 501 515		1	1.VİTES MASURA BİLYA SEK.	RETAINING RING	3.40mm	◆	◆	◆
49		0630 501 338		1	1.VİTES MASURA BİLYA SEK.	RETAINING RING	3.60mm	◆	◆	◆
50		0750 115 283		1	1.VİTES MASURA BİLYA	NEEDLE CAGE	80,0X88,0X46,0mm	◆	◆	◆
51	K20.01907	1268 304 568		1	1.VİTES DIŞLİSİ	GEAR 1st		◆	◆	◆
52	K20.02017	1250 304 006		1	GERİ VİTES YILDIZ DİŞLİ	HUB		◆	◆	◆
53	K20.02066	0730 160 344		1	GERİ VİT.MAS.BİLYA ÇANAĞI	BEARING RACE		◆	◆	◆
54		0735 320 154		1	GERİ VİTES MASURA BİLYA	NEEDLE CAGE		◆	◆	◆
55	K20.01909	1268 304 008		1	GERİ VİTES DIŞLİSİ 47 DİŞ	REVERSE GEAR 47 T		◆	◆	◆
56		1246 206 008		1	GERİ VİTES HİLALİ	G.SHIFT FORK RG		◆	◆	◆
57		1268 306 035		1	GERİ VİTES HİLAL ARA PARÇA	SLIDING FORK		◆	◆	◆
58		1240 306 214		1	GERİ VİTES HİLAL ÇİTASI	SELECTOR ROD		◆		◆
58		0091 306 036		1	GERİ VİTES HİLAL ÇİTASI	SELECTOR ROD			◆	
59		0091 301 036		1	ŞANZIMAN ORTA GÖVDE	HOUSING		◆	◆	◆
60		0730 002 672		1	ARKA GÖVDE RAYNELİ	SHIM	1.00mm	◆	◆	◆
60		0730 002 665		1	ARKA GÖVDE RAYNELİ	SHIM	1.70mm	◆	◆	◆
61		1268 308 020		1	ARKA GÖVDE CONTASI	GASKET		◆	◆	◆
62		0091 308 004		1	ŞANZIMAN ARKA GÖVDE	REAR HOUSING		◆		◆
62		0091 308 044		1	ŞANZIMAN ARKA GÖVDE	REAR HOUSING			◆	
63		0734 310 109		1	ŞANZ.ARKA GÖVDE BİL.KEÇESİ	OIL SEAL	85.0X105.0X10.0mm	◆	◆	◆
64	K20.02075	0634 300 712		1	ŞANZ.ARKA GÖVDE BİL.KEÇESİ	OIL SEAL	85.0X105.0X10.0mm	◆	◆	◆
65	K20.02121	0630 503 020		1	ŞANZ.ARKA GÖVDE BİL.KİLİT SEK.	LOCK RING		◆	◆	◆
66		1250 304 198		1	ŞANZIMAN KM DIŞLİSİ	GEAR		◆	◆	◆
67	K20.02062	1269 338 020		1	ŞANZIMAN FLANŞI	COMPANION FLANGE	10-H, Ø180mm	◆		
67		0091 204 015		1	ŞANZIMAN FLANŞI	COMPANION FLANGE			◆	
67		1268 304 136		1	ŞANZIMAN FLANŞI	COMPANION FLANGE	8-H, Ø150mm			◆

NOTES :

X1,X2,X3 are used in conjunction with the encoded parts.

NOTLAR :

X1,X2,X3 ile kodlanan parçalar birlikte kullanılır.

6 S 1550

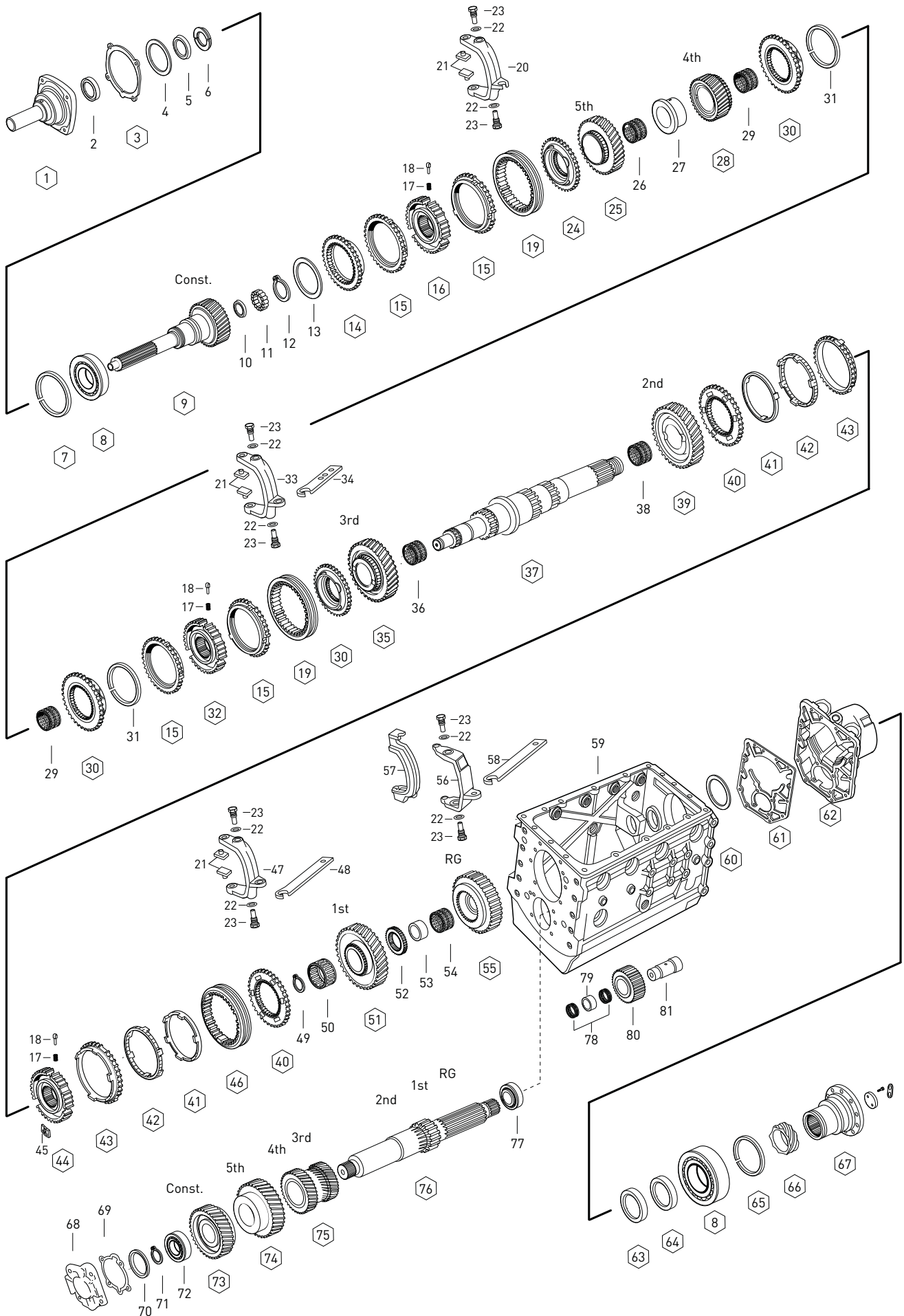

Fig. Kacmaz No.	Oem No	Oem Old No	Pcs.	Ürün Tanımı	Description	Sizes	X1 :1268 008 605	X2 :1268 008 607	X3 :1268 008 624
68	1268 303 066		1	KAPAK	COVER		◆	◆	◆
69	1268 303 132		1	KAPAK CONTASI	GASKET		◆	◆	◆
70	0730 103 124		1	GRUP MİLİ ÖN BİLYA RAYNELİ	SHIM	3.60mm	◆	◆	◆
71	0630 501 147		1	GRUP MİLİ ÖN BİLYA SEKMANI	RETAINING RING	2.30mm	◆	◆	◆
71	0630 501 151		1	GRUP MİLİ ÖN BİLYA SEKMANI	RETAINING RING	3.20mm	◆	◆	◆
72	0750 117 030		1	GRUP MİLİ ÖN BİLYA	ROLLER BEARING		◆	◆	◆
73	K20.01808 1268 303 140		1	TAKVİYE DİŞLİ KARŞILIĞI 46 DİŞ	CONSTANT GEAR 46 T		◆	◆	◆
74	K20.01800 0091 303 030		1	5.VİTES DİŞLİ KARŞILIĞI 39 DİŞ	GEAR 5th 39 T		◆	◆	◆
75	K20.01910 0091 303 031		1	3./4.VİTES DİŞLİ KARŞILIĞI 27/21 DİŞ	DOUBLE GEAR 3rd/4th 27/21 T		◆	◆	◆
76	K20.01801 0091 303 136	(1268 303 138)	1	GRUP MİLİ	COUNTER SHAFT		◆		◆
76	K20.01911 0091 303 080		1	GRUP MİLİ	COUNTER SHAFT			◆	
77	0635 374 019		1	GRUP MİLİ ARKA BİLYA	ROLLER BEARING	45.0X100.0X38.25mm	◆	◆	◆
78	0735 320 492		1	KÜÇÜK GERİ VİTES MASURA BİLYA	NEEDLE CAGE	45.0X53.0X21.0mm	◆	◆	◆
79	1250 305 006		1	KÜÇÜK GERİ VİT.MAS.BİLYA ÇANAĞI	BEARING RACE		◆	◆	◆
80	K20.01912 1268 305 009		1	KÜÇÜK GERİ VİTES 20 DİŞ	REV.IDLER GEAR 20 T		◆	◆	◆
81	K20.02077 1250 305 003		1	KÜÇÜK GERİ VİTES PİMİ	PIN		◆	◆	◆

6 S 1550

NOTES :
X1,X2,X3 are used in conjunction with the encoded parts.

NOTLAR :
X1,X2,X3 ile kodlanan parçalar birlikte kullanılır.